

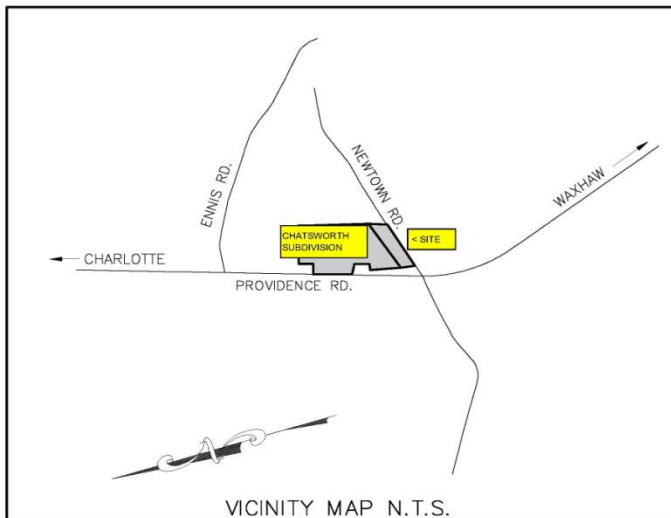

PAPPAS PROPERTIES

PRIME OUTPARCEL AVAILABLE

Located near corner of Providence Rd at New Town Rd



- Build to Suit/Ground Lease
- +/- 2.4 Acres located on New Town Road near Providence Road intersection
- Utilities available at site
- Suitable site for Convenience Store, Drug Store, Bank or Daycare
- Excellent Visibility

For More Information Call Kate Caltis 704-716-3905



PAPPAS PROPERTIES

PRIME OUTPARCEL AVAILABLE

Located near corner of Providence Rd at New Town Rd



For More Information Call Kate Caltis 704-716-3905